

# KCMA APPROVED *ALL WOOD CABINETS*

*"D"* Decorative Maple Cabinets



## *Features:*

- ALL WOOD CONSTRUCTION • 1/2" PLYWOOD SIDES
- 3/4" SOLID MAPLE FACE FRAMES • EURO/CONCEALED HINGE
- 5/8" ADJUSTABLE PLYWOOD SHELVES • DRAWER BOX w/1/2" PLYWOOD SIDES
- EPOXY COATED DRAWER GLIDES • RAISED PANEL MAPLE DOORS WITH MOULDINGS
- 4-1/2" TOE SPACE with ALL WOOD TOE KICKS

## WALL CABINETS 12" DEEP

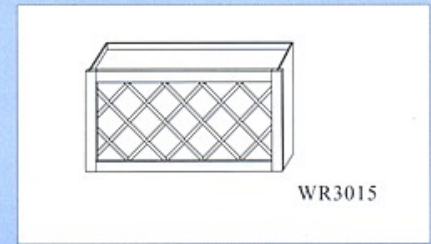
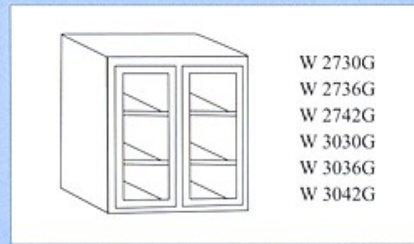
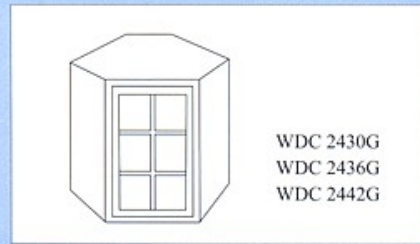
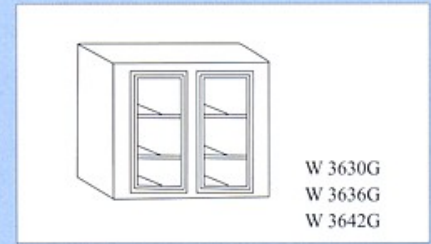
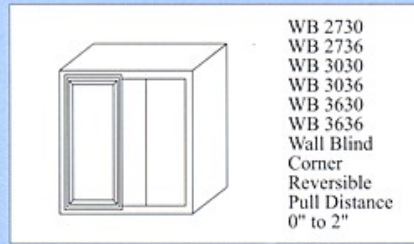
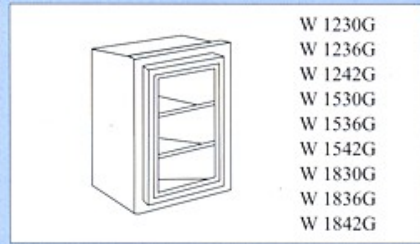
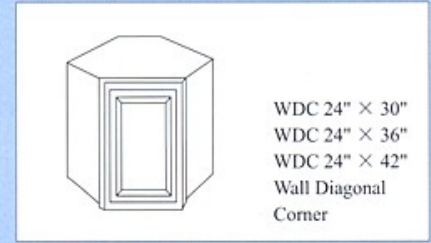
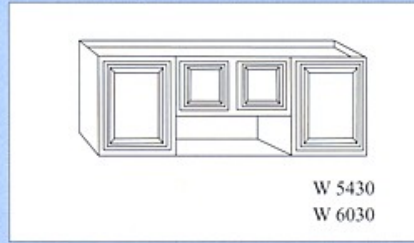
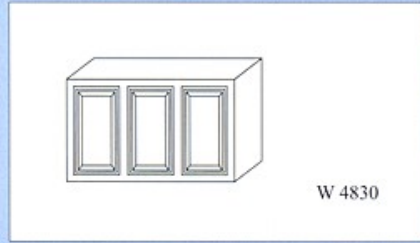
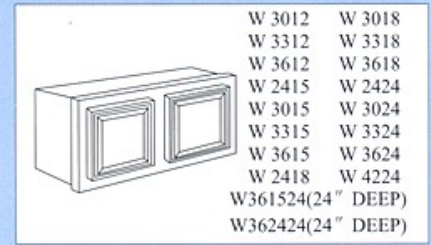
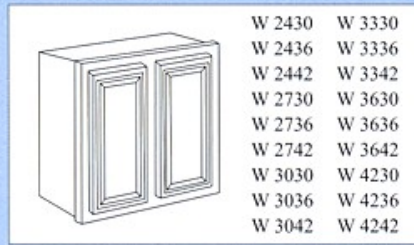
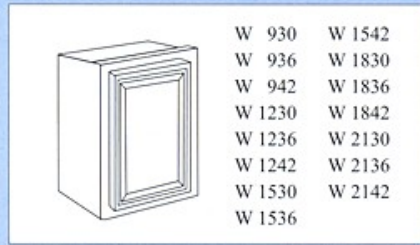

## BASE CABINETS 34 - 1/2" HIGH & 24" DEEP

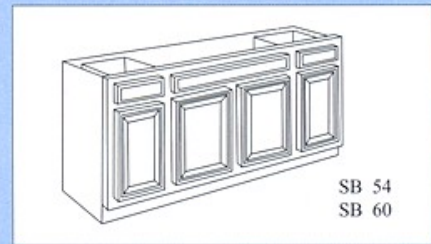
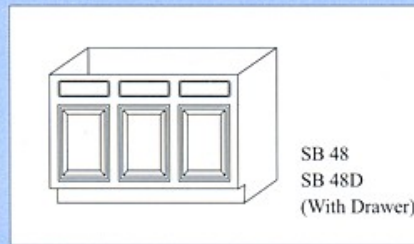
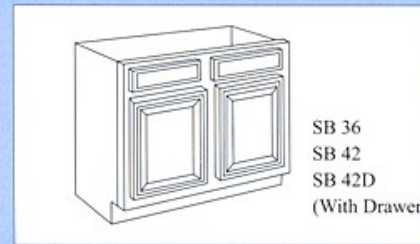
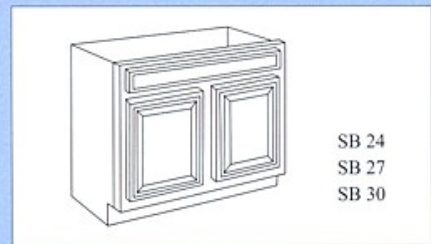
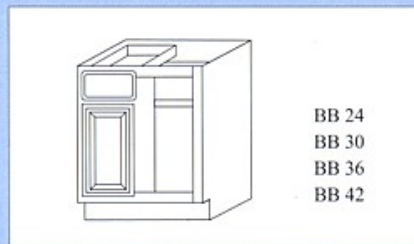
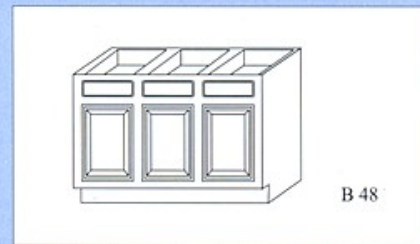
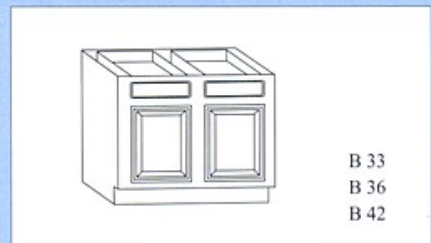
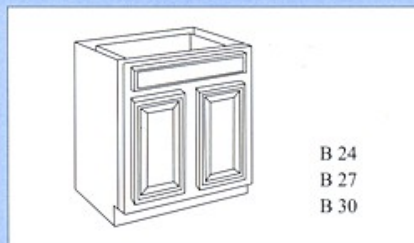
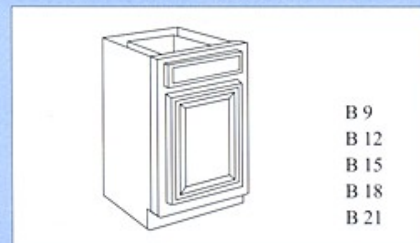

## TALL CABINETS (84" HIGH)

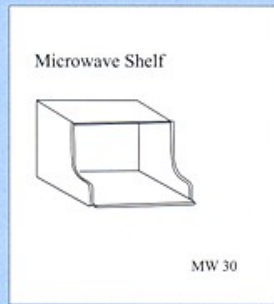
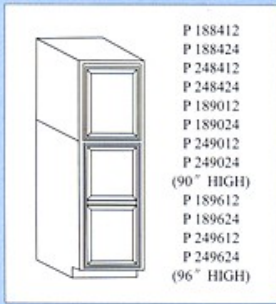

## BASE CABINETS 34-1/2" HIGH & 24" DEEP

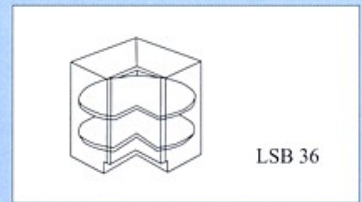
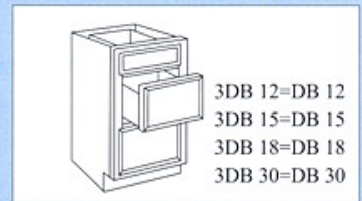

## VANITIES

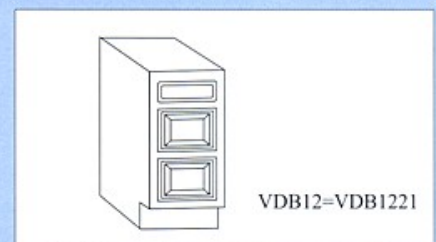
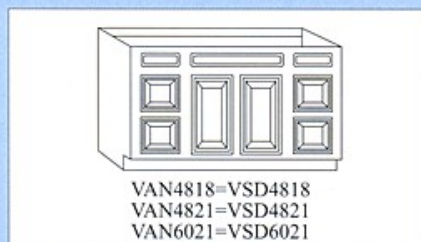
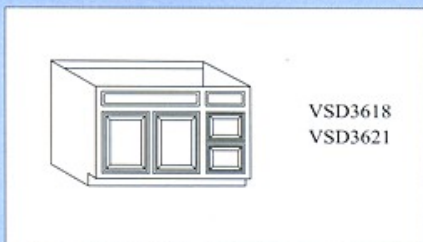
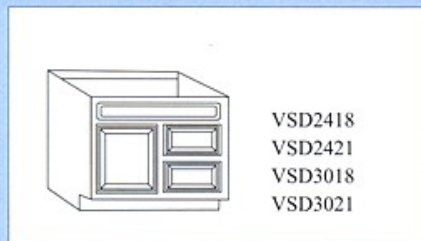
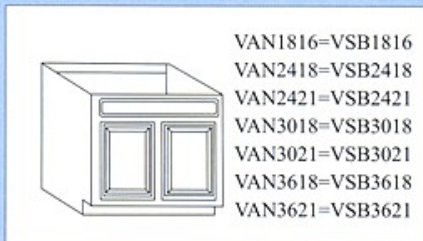

## SPECIALTY UNITS

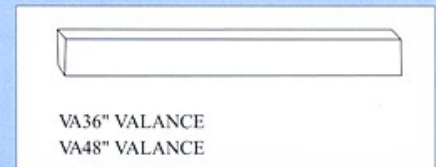
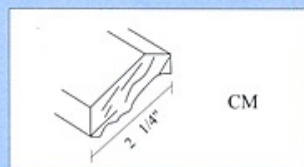
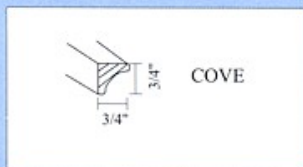
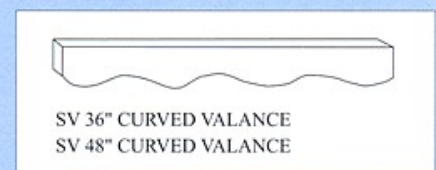
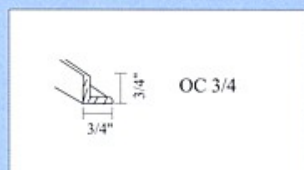
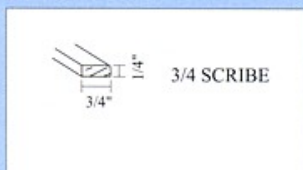
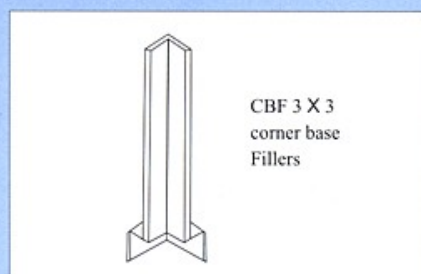
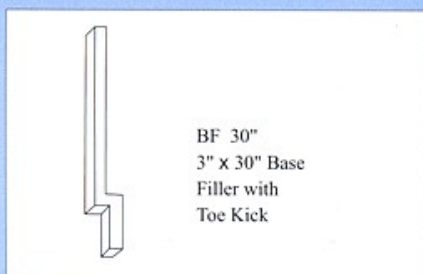
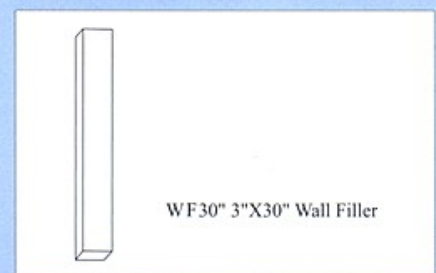
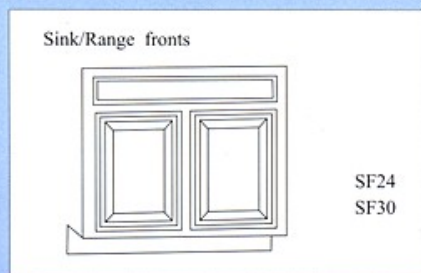

# *All Wood Vanities*

